

3R-491 is a pallet for the Junior tooling system.

The pallet is prepared with three through holes to mount workpiece, fixture or other.

- X / Y / Z - references are solid
- Not rustproof
- Permissible torque: 20 Nm (counterclockwise)
- Supplied in set of 30 pcs
- Weight: 0.04 kg/pc
- Requires drawbar: 3R-405.11 or similar

Accessories

Chuck: 3R-400.xx Junior chuck or 3R-460.xx Combi chuck*

Drawbar: 3R-405.11 or similar

Screws: 3R-PI4.5x20E self-threading screw

Other: 3R-404-25 soldering kit

Code carrier: 3R-863.25-10 carrier

Make sure nut is in place before assembly

Direct mounting: add Permabond C4 for graphite or solder for copper

If drawbar 3R-405.11 is used, please apply 2.5 ± 0.5 Nm.

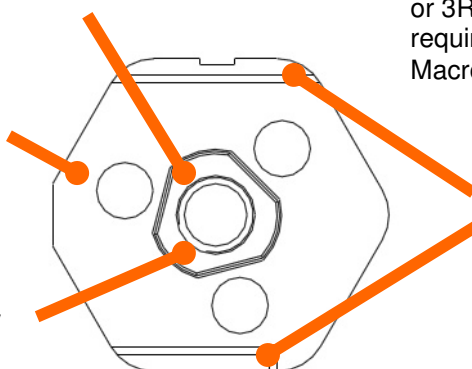

Gripper interface for automation.

* Combi chucks require a spacer by $\varnothing 32 \times 5.5$ mm or 3R-SP19269 or 3R-SP19270 as minimum requirement. This to avoid crash to xy-references of Macro in Combi chuck. **See TPS for 3R-PI4.5x20.**

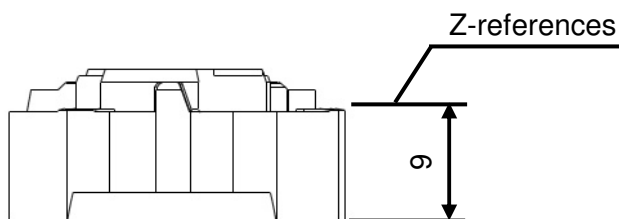

For cutting data, please read instruction manual that comes with the pallets.

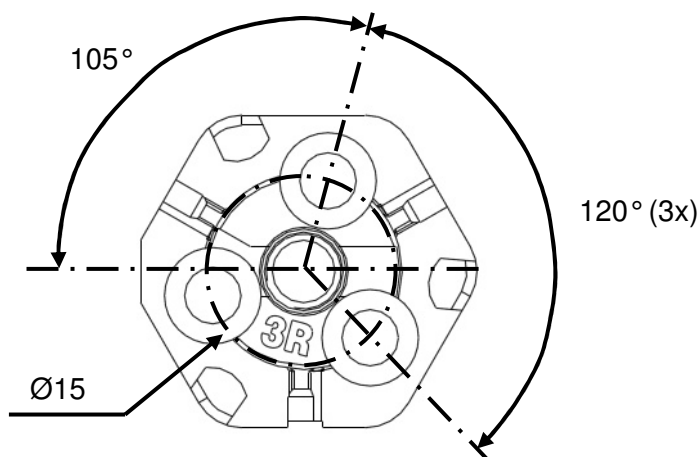

Before assembly, do read instruction manual for alternative assembly.